

LIVINGSTON OPTIONAL EXTENDED GREAT ROOM

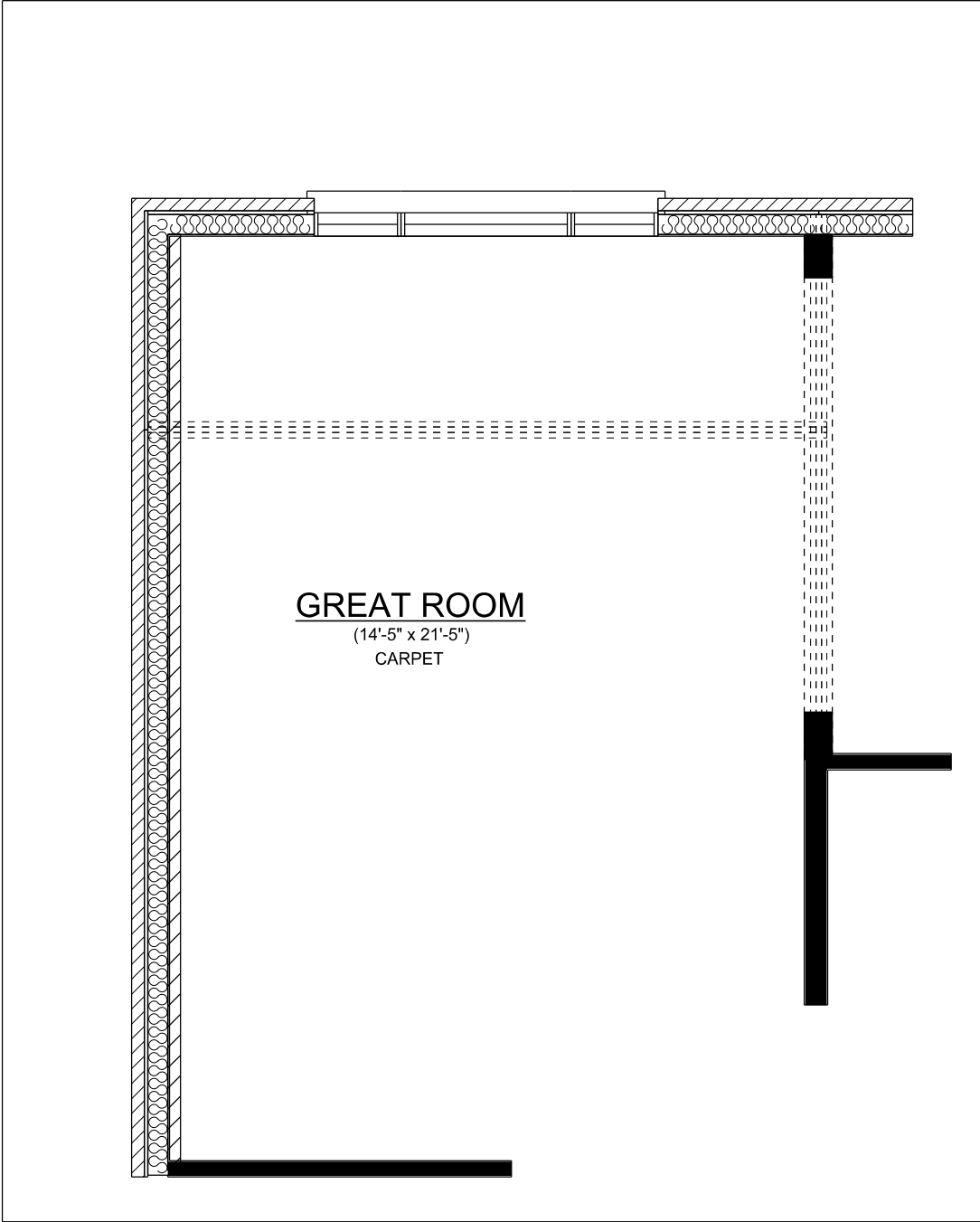

extend rear wall to make flush across the back of the home increasing the great room and basement size (adds 70sq ft to the home). Enlarge arch between Great Room and Breakfast Area to 10 ft. and add mechanical chase wall to great room side wall. Add roof to rear of home over extended Great Room. Add beams to hold up 2nd floor.

(note: this shows structure for main & bsmt extension only)